

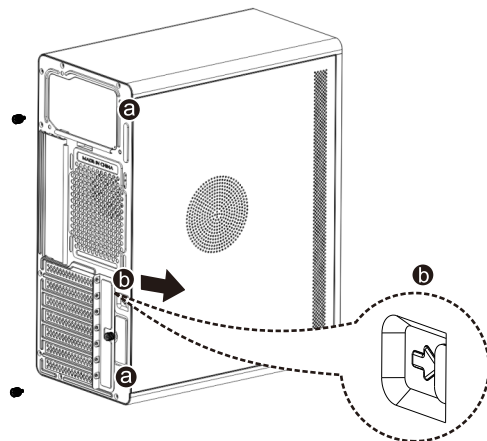

1 Disassemble Of Side Panels

- ① Unscrew the 2 screws at "a" positions of left side panel as shown in the illustration;
- ② Push the side panel out at "b" position of the rear end by thumb (Caution: if it's tempered glass side panel, please hold it by the other hand to prevent it falling down)



2 PSU installation

Install PSU in the positions as shown in the illustration, then fix it by 4 screws at "a" positions

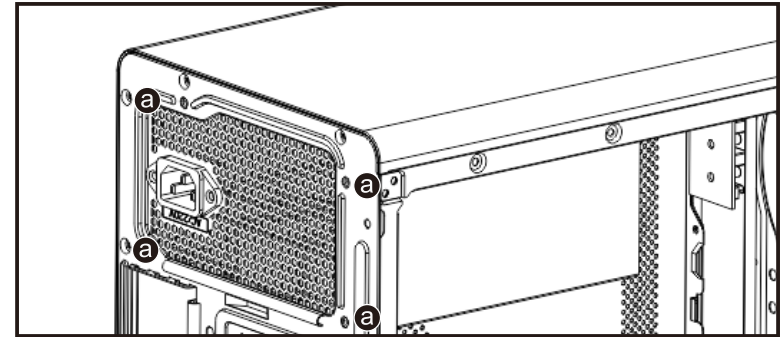

3 M/B installation

Put M/B in the case and align the screw holes, then fix M/B by screws as shown in the following illustration (this case support micro ATX M/B and ITX M/B) (different M/B has different installation characteristics, please refer to the user manual of your M/B before installation)

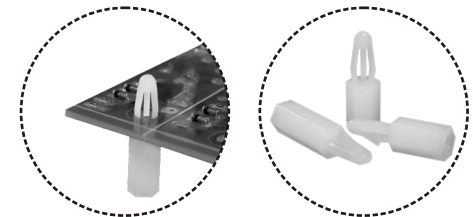
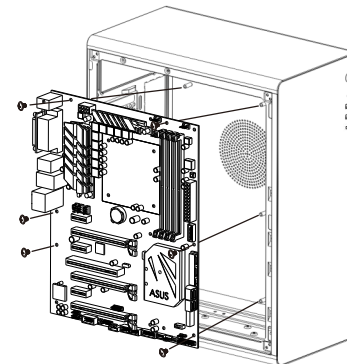

★ If there is no screw pillar under any hole of the motherboard, please take out the plastic fixing pillar from accessories bag and insert it into the hole of the motherboard to hold up the motherboard

4 VGA card installation

- ① Unscrew the screws of the fastening bar of the PCI slot covers, remove the fastening bar, then break off PCI slot covers
- ② Insert VGA card into the slot of M/B according to the arrow direction; Fix VGA card by screws

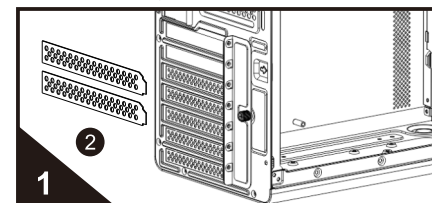

1 Unscrew the screws of the fastening bar of the PCI slot covers, remove the fastening bar, then break off PCI slot covers

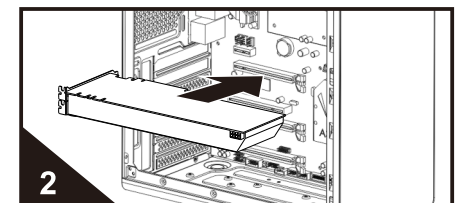

2 Insert VGA card into the slot of M/B according to the arrow direction

5 HDD / SSD installation (Support: HDD*1+SSD*5; OR HDD*2+SSD*4)

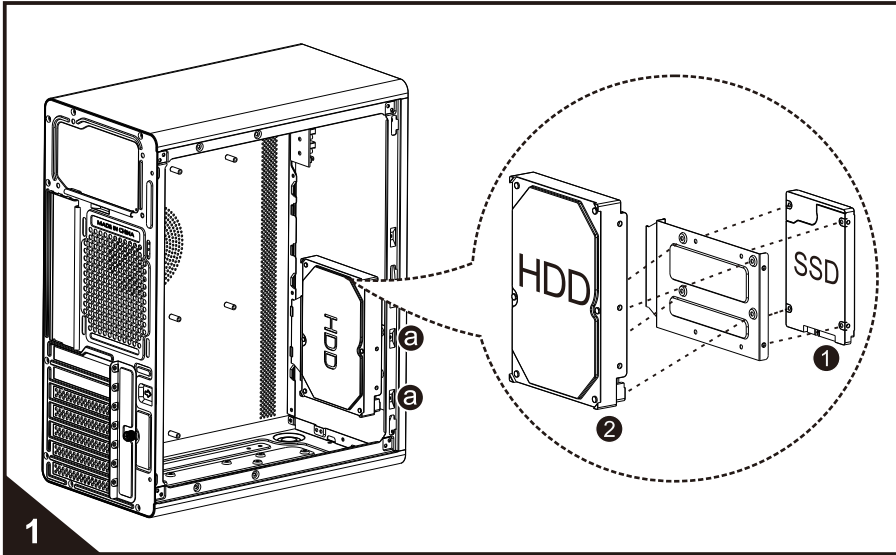

Fix 2.5" SSD and 3.5" HDD on HDD/SSD bracket by screws, then install the bracket on the front plate, fasten the screws at "a" positions

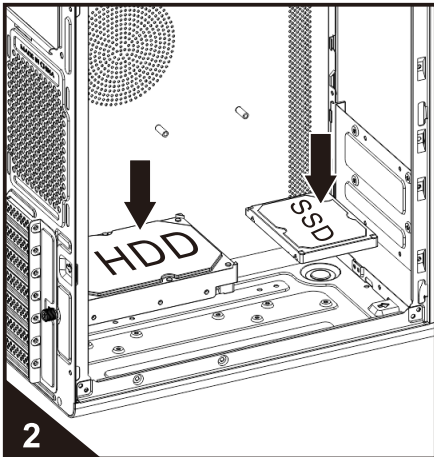

Put 3.5" HDD and 2.5" SSD on the bottom plate, align screw holes, fix it from the bottom by screws

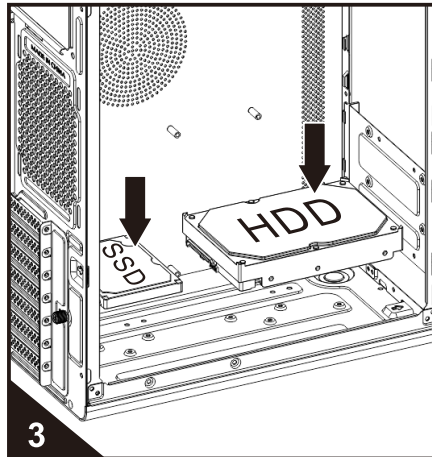

Or put 2.5" SSD and 3.5" HDD on the bottom plate, align screw holes, fix it from the bottom by screws

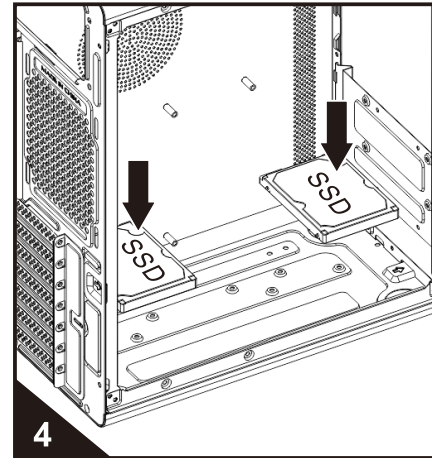

Or put 2*2.5" SSD on the bottom plate, then fix the two SSD from the bottom by screws

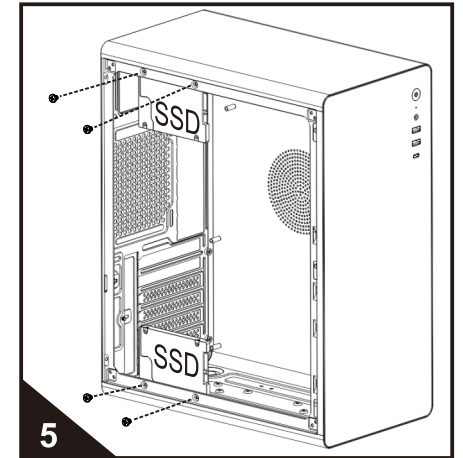

Both the side of top plate and the side of bottom plate can be installed with one 2.5" SSD (Remark: under this circumstance, the SSD can only be fixed by two screws)

6 Cooling device compatibility

Rear plate: 1*12cm fan or 1*120mm water cooling kit